

SEE NOTES ON SHEET 4.

C.A. Ingraham 1997-08-04
 C.A. Ingraham 1998-07-05
 C.A. Ingraham Schematic, MEP DPU Engineering Model
 8097-17
 18/AVGEL ... 10/DPUPDPER 2 of 4 G

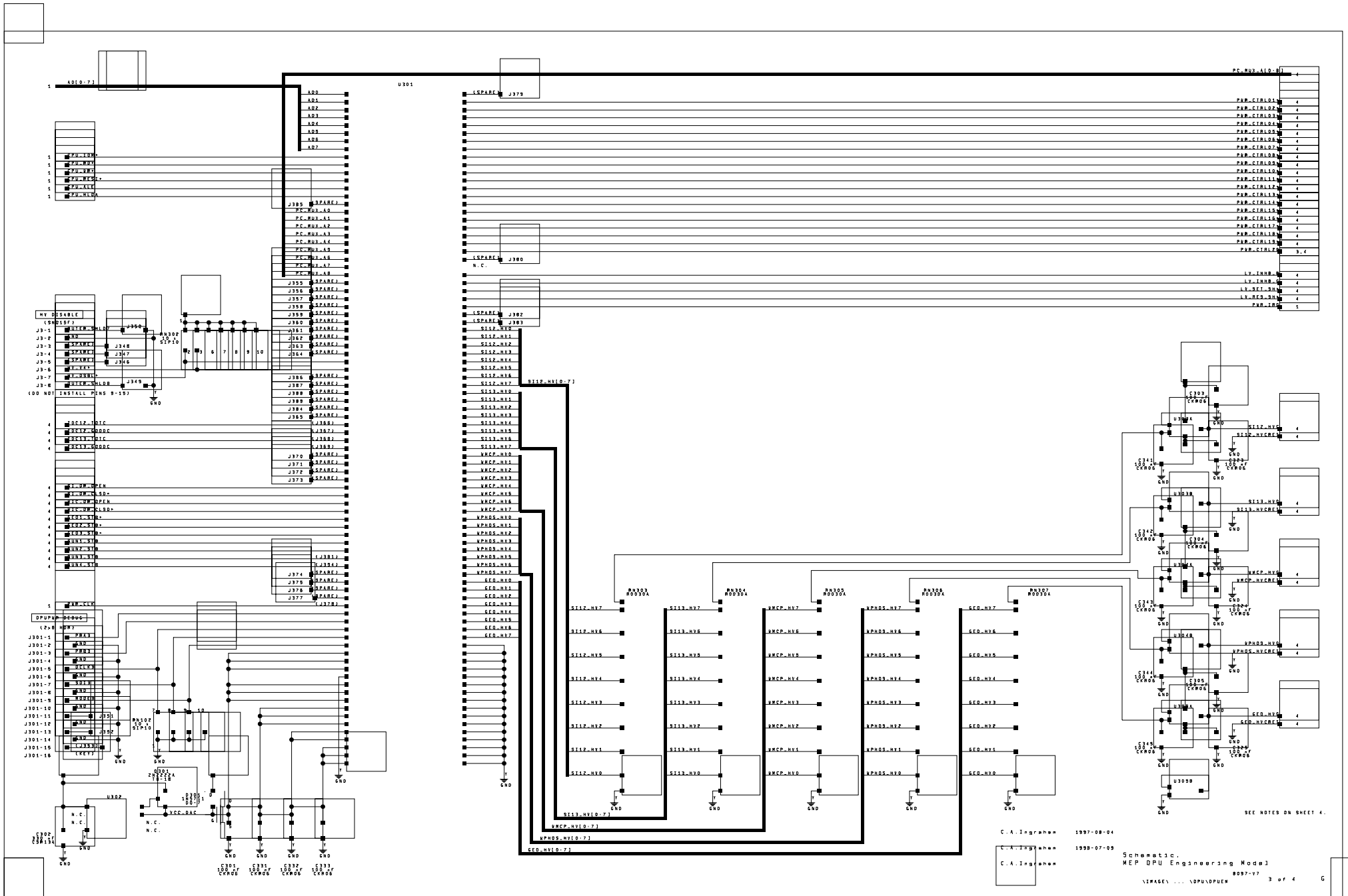

SEE NOTES ON SHEET 4.

C. A. Ingraham 1997-08-04
 C. A. Ingraham 1998-07-05
 C. A. Ingraham

Schematic Engineering Model
 MEP DPU Engineering Model
 8097-17
 3 of 4

NOTES:

- 1. N.C. means no connection to this pin.
- 2. This means "to sheet 2".
- 3. This means "from sheet 1".
- 4. This represents pin 3 of connector J43.
- 5. Signal flow is from left to right.
- 6. Resistance values are in Ohms.
- 7. This is a small hole and does not require a short, exposed outer layer trace.
- 8. This is a small hole and does not require a short, exposed outer layer trace.
- 9. This represents a mounting screw of connector J43.
- 10. This is a (unpopulated) pin connector, not signal pins.
- 11. Asterisk suffix denotes active-low signal.

P1	1997-08-04	Preliminary	Created from 88 Rev. P7.
P2	1997-08-07	Drawn	Drawn by: [Name]
A	1997-08-15	Analysis	Analysis by: [Name]
B	1997-08-15	PCB	PCB Design
C	1997-08-15	Review	Review by: [Name]
D	1997-11-15	Review	Review by: [Name]
E	1997-11-15	Review	Review by: [Name]
F	1998-04-10	Review	Review by: [Name]
G	1998-07-08	Review	Review by: [Name]

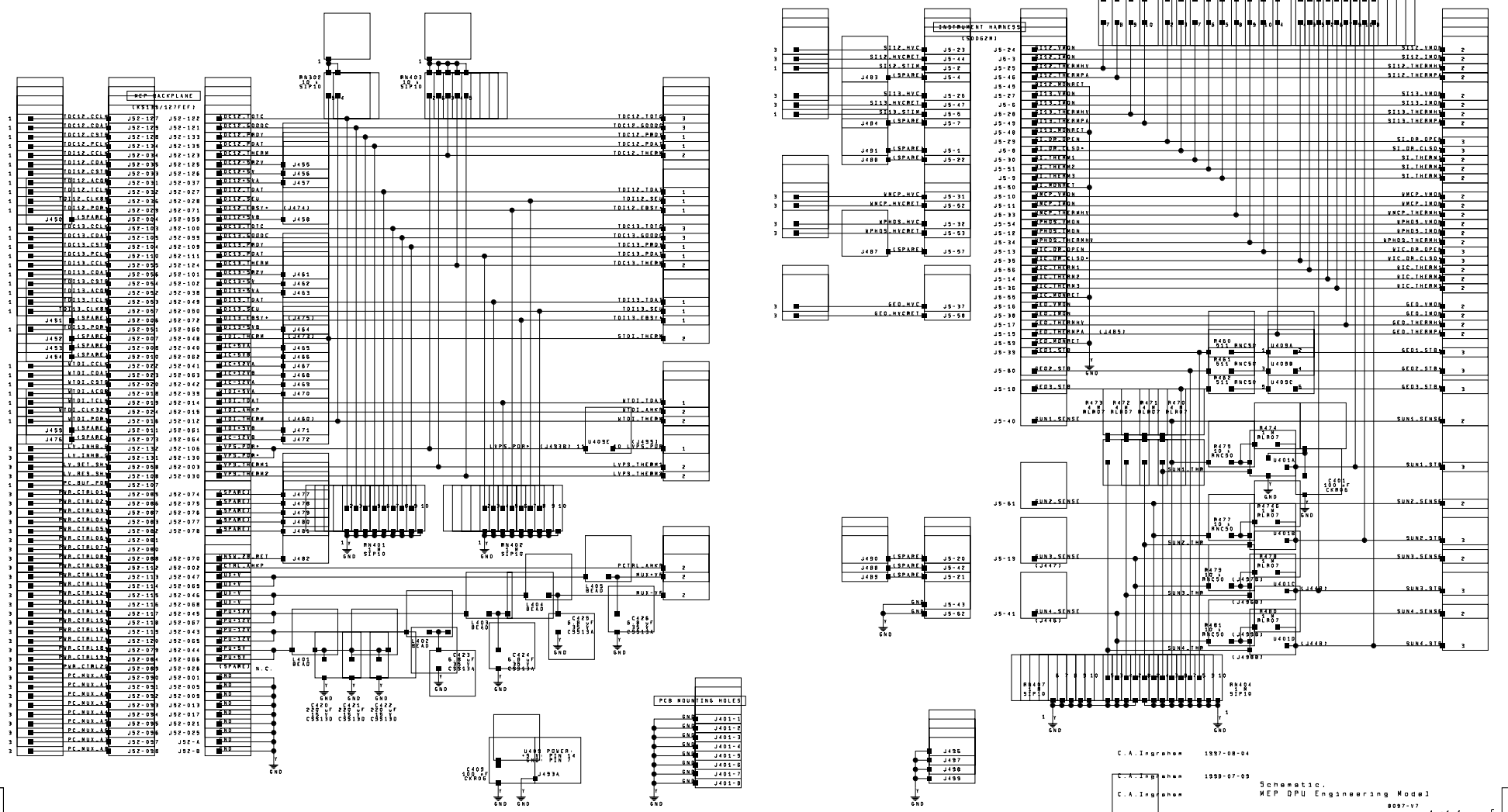

C.A. Ingraham 1997-08-04
 C.A. Ingraham 1998-07-08
 Schematic Engineering Model
 1818XCEL ... 10P0V0P08 8097-17 4 of 4 G