

REVISIONS			
REV.	DESCRIPTION	DATE	APPROVED
B	ADDED Ø10 HOLE	6/29/98	

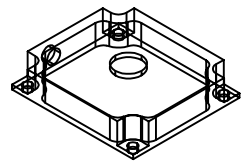

- NOTES, UNLESS SPECIFIED OTHERWISE:
1. REMOVE BURRS & BREAK SHARP EDGES, R0.15 MAX
 2. IDENTIFY PART BY BAGGING AND TAGGING
 3. MATERIAL CERTS REQUIRED

1	A/R	ACETAL (DELTRIN)	L-P-324A
ITEM#	QTY	PART NUMBER	NOMENCLATURE
TOLERANCES (EXCEPT AS SPECIFIED)		DO NOT SCALE DRAWING	
OVER	TO	METRIC DRAWING	
0	49.99	(UNITS: mm)	
50	249.9	INTERPRET PER ANSI Y14.5-1994	
250		WELDING SYMBOLS PER ANSI/ASME A24-79	
ANGLES		APPROVALS	
		DATE	
SURFACE FINISH 1.6		DRAWN K. KROMER 1/15/98	
SURFACE TREATMENT		CHECKED	
NONE		ISSUED	
MASS 7.5g		SCALE FULL	
		SHEET 1 OF 1	

Space Sciences Laboratory
UNIVERSITY OF CALIFORNIA, BERKELEY, USA

DWG TITLE: PORT COVER
FUV WIC INTERFACE HOUSING

SIZE: A PROGRAM: IMAGE DWG. NO.: 8245-A4 REV: B

