

25.4 mm
1 inch

REVISIONS			
REV.	DESCRIPTION	DATE	APPROVED
A	BASELINE RELEASE	1/9/98	

NOTES:

1. BOND ADAPTER TO TAPER USING 3M 2216 EPOXY
2. MACHINE OD OF ADAPTER TO FINAL DIMENSION SHOWN. TAKE EXTREME CARE NOT TO DAMAGE TAPER OPTICAL SURFACES

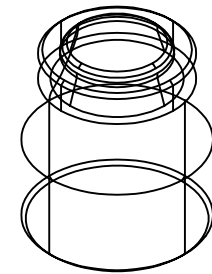
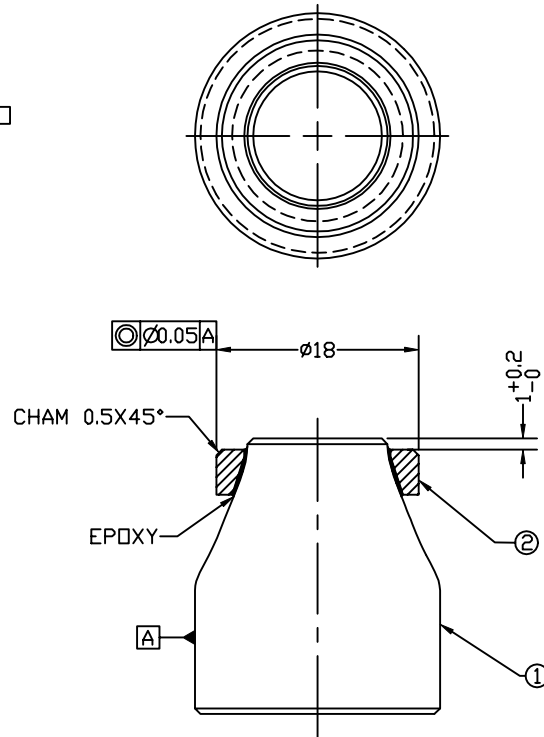

ITEM#	QTY	PART NUMBER	NOMENCLATURE	MATERIAL SPECIFICATION
2	1	8239	TAPER ADAPTER	PEEK
1	1	8084	FIBER OPTIC TAPER	SCHOTT 32

TOLERANCES (EXCEPT AS SPECIFIED) <table border="1"> <thead> <tr> <th>OVER</th> <th>TO</th> <th>TOLERANCE</th> </tr> </thead> <tbody> <tr> <td>0</td> <td>49.99</td> <td>±0.1</td> </tr> <tr> <td>50</td> <td>249.9</td> <td>±0.5</td> </tr> <tr> <td>250</td> <td>-</td> <td>±1</td> </tr> </tbody> </table>			OVER	TO	TOLERANCE	0	49.99	±0.1	50	249.9	±0.5	250	-	±1	DO NOT SCALE DRAWING METRIC DRAWING (UNITS: mm) INTERPRET PER ANSI Y14.5-1994 WELDING SYMBOLS PER ANSI/AWS A2.4-79		<i>Space Sciences Laboratory</i> UNIVERSITY OF CALIFORNIA, BERKELEY, USA		
OVER	TO	TOLERANCE																	
0	49.99	±0.1																	
50	249.9	±0.5																	
250	-	±1																	
SURFACE FINISH 1.6 ✓			DWG TITLE TAPER ASSY FUV WIC DETECTOR																
SURFACE TREATMENT			APPROVALS DRAWN K. KROMER 1/9/98		DATE 1/9/98														
MASS			CHECKED	ISSUED	SIZE A														
			PROGRAM IMAGE	DWG. NO. 8182-A4	REV A														
			SCALE 2:1	SHEET 1 OF 1															