

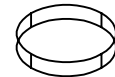

25.4 mm
1 inch

REVISIONS			
REV.	DESCRIPTION	DATE	APPROVED
A	BASELINE RELEASE	10/29/97	

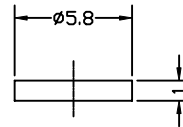
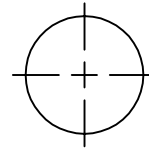

1	A/R		304 STAINLESS STEEL	QQ-S-763																		
ITEM#	QTY	PART NUMBER	NOMENCLATURE	MATERIAL SPECIFICATION																		
<table border="1"> <thead> <tr> <th colspan="3">TOLERANCES (EXCEPT AS SPECIFIED)</th> </tr> <tr> <th>OVER</th> <th>TO</th> <th>TOLERANCE</th> </tr> </thead> <tbody> <tr> <td>0</td> <td>49.99</td> <td>±0.1</td> </tr> <tr> <td>50</td> <td>249.9</td> <td>±0.5</td> </tr> <tr> <td>250</td> <td>-</td> <td>±1</td> </tr> <tr> <td colspan="2">ANGLES</td> <td>±1°</td> </tr> </tbody> </table>			TOLERANCES (EXCEPT AS SPECIFIED)			OVER	TO	TOLERANCE	0	49.99	±0.1	50	249.9	±0.5	250	-	±1	ANGLES		±1°	DO NOT SCALE DRAWING METRIC DRAWING (UNITS: mm) INTERPRET PER ANSI Y14.5-1994 WELDING SYMBOLS PER ANSI/ASME A24-79	
TOLERANCES (EXCEPT AS SPECIFIED)																						
OVER	TO	TOLERANCE																				
0	49.99	±0.1																				
50	249.9	±0.5																				
250	-	±1																				
ANGLES		±1°																				
SURFACE FINISH 0.8 ✓			<i>Space Sciences Laboratory</i> UNIVERSITY OF CALIFORNIA, BERKELEY, USA																			
SURFACE TREATMENT NONE			DWG TITLE PRESSURE PAD FUV WIC DETECTOR MOUNT																			
MASS 0.2g			APPROVALS DRAWN K. KROMER 10/29/97 CHECKED ISSUED	DATE 10/29/97 SIZE A PROGRAM IMAGE DWG. NO. 8169-A4 REV A																		
			SCALE 4:1	SHEET 1 OF 1																		

