

REVISIONS			
REV.	DESCRIPTION	DATE	APPROVED
A	BASELINE RELEASE	5/19/97	D.S.

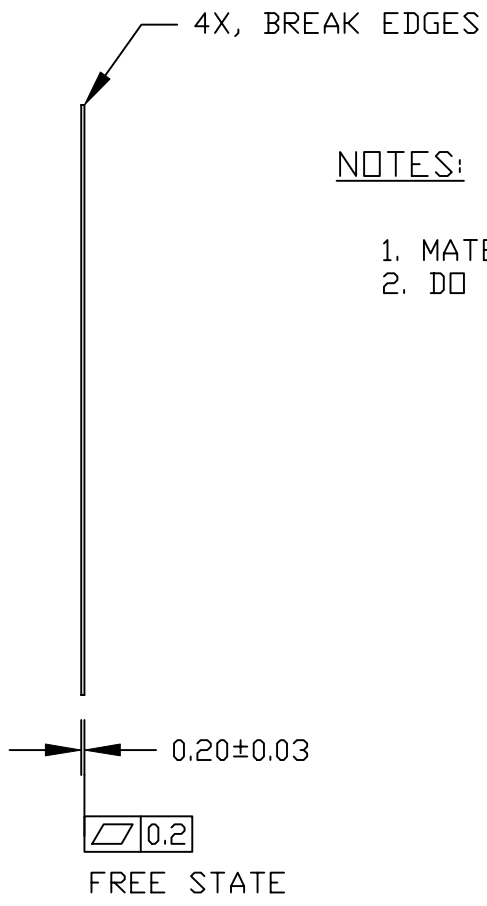
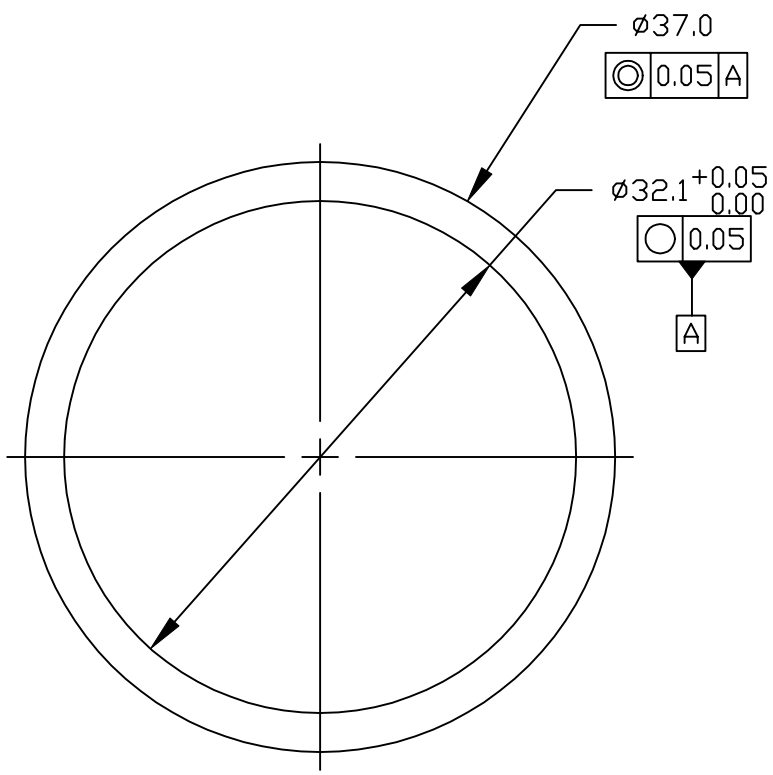

NOTES:

1. MATERIAL CERT'S REQUIRED.
2. DO NOT USE SULFUR OILS.

25 mm

		SHIM STOCK		17-7 COND. C	
ITEM#	QTY	PART NUMBER	NOMENCLATURE		MATERIAL SPECIFICATION
TOLERANCES (EXCEPT AS SPECIFIED)			DO NOT SCALE DRAWING METRIC DRAWING (UNITS: mm)		
OVER	TO	TOLERANCE	INTERPRET PER ANSI Y14.5-1982 WELDING SYMBOLS PER ANSI/AWS A2.4-79		
0	49.99	± 0.1	APPROVALS		
50	249.9	± 0.5	DATE		
250	-	± 1	DRAWN J. STOCK 5/19/97		
ANGLES		$\pm 0.1^\circ$	CHECKED D. SIEGMUND 5/19/97		
SURFACE FINISH		0.2	ISSUED J. STOCK 5/19/97		
SURFACE TREATMENT		ELECTROPOLISH	SIZE A		
NEXT		FINAL	PROGRAM		DWG. NO.
QTY REQD PER ASSY		NEXT ASSY	IMAGE		(PREV. 8536) 8072-A3
APPLICATION		USED ON	SCALE 2:1		REV A
		MASS	SHEET 1 OF 1		

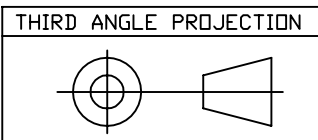

Experimental Astrophysics Group
UNIVERSITY OF CALIFORNIA, BERKELEY, USA

DWG TITLE MCP CLAMPING SPRING
SI DETECTOR